

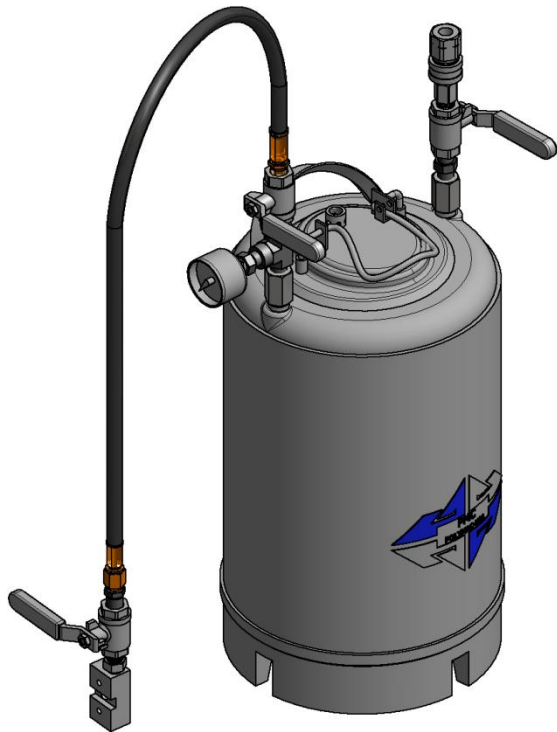

**POLYURETHANE
MACHINERY
CORPORATION**



200426

200427

2.5 Gallon Flush Tank

**For Professional Use Only
Not approved for use in explosive
atmosphere locations**

Service Manual

Ref. # MN-04025

Revision 1.2

October 20, 2020



Polyurethane Machinery Corp.

Corporate: 1 Komo Dr, Lakewood, NJ 08701

Manufacturing: 2 Komo Dr, Lakewood, NJ 08701

Phone: 732-415-4400

Fax: 732-364-4025

URL: <http://www.polymac-usa.com>



Before using the Flush Tank, carefully read all the technical and safety documentation included in this manual. Pay special attention to the information in order to know and understand the operation and the conditions of use of the Flush Tank. All of the information is aimed at improving user safety and avoiding possible breakdowns from the incorrect use of the Flush Tank.

TABLE OF CONTENTS

WARRANTY	1
SAFETY AND HANDLING	3
CHARACTERISTICS	5
TECHNICAL SPECIFICATIONS	5
DESCRIPTION	6
START UP	7
FLUSHING PROCEDURE.....	8
PART IDENTIFICATION	9
Flush Tank Assemblies.....	9
Flush Tank Body Assembly	10
Coupling Block Assemblies.....	11

WARRANTY

Polyurethane Machinery Corporation (hereinafter “PMC”) provides this **LIMITED WARRANTY** (hereinafter “Warranty”) to the original purchaser (hereinafter “Customer”) covering this equipment and the original PMC manufactured accessories delivered with the equipment (hereinafter “Product”) against defects in material or workmanship of the Product (hereinafter “Defect” or “Defective”) for a period of one (1) year from the date of first purchase as shown on the original PMC invoice (hereinafter “Warranty Period”).

If during the Warranty Period under normal use, the Product is suspected by Customer to be Defective in material or workmanship, it is Customer’s responsibility to contact PMC and return the Product to PMC as directed by PMC, freight prepaid. If PMC determines that the Product is Defective and that such Defect is covered by this Warranty, PMC will credit Customer for the reasonable freight charges incurred by Customer in returning the Defective Product to PMC, and PMC (or its authorized agent) will, at PMC’s option, repair or replace the Product, subject to the following:

Original Invoice: The original invoice must be kept as proof of the date of first sale and the Product serial number. The Warranty does not cover any Product if the Original Invoice appears to have been modified or altered, or when the serial number on the Product appears to have been altered or defaced.

Product Maintenance: It is the Customer’s responsibility to maintain the Product properly. See your maintenance schedule and owner’s manual for details. The Warranty does not cover an improperly maintained Product.

Non-PMC Components and Accessories: Non-PMC manufactured components and accessories that are used in the operation of the Product are not covered by this Warranty. Such components and accessories shall be subject to the warranty offered to the Customer, if any, by the original manufacturer of such component or accessory.

Other Warranty Exclusions: The Warranty does not cover any Product that PMC determines has been damaged or fails to operate properly due to misuse, negligence, abuse, carelessness, neglect, or accident. By way of example only, this includes:

- Normal wear and tear.
- Improper or unauthorized installation, repair, alteration, adjustment or modification of the product.
- Use of heating devices, pumping equipment, dispensers, or other parts or accessories with the product that have not been approved or manufactured by PMC.
- Failure to follow the operating instructions and recommendations provided by PMC.
- Cosmetic damage.
- Fire, flood, “acts of God,” or other contingencies beyond the control of PMC.

THE WARRANTY DESCRIBED HEREIN IS THE EXCLUSIVE REMEDY FOR THE CUSTOMER AND IS IN LIEU OF ALL OTHER WARRANTIES, EXPRESS, IMPLIED, STATUTORY OR OTHERWISE, AND THE IMPLIED WARRANTIES OF MERCHANTABILITY AND FITNESS FOR A PARTICULAR PURPOSE AND ALL OTHER WARRANTIES ARE HEREBY DISCLAIMED. TO THE FULLEST EXTENT PERMITTED BY LAW, PMC SHALL NOT BE RESPONSIBLE, WHETHER BASED IN CONTRACT, TORT (INCLUDING, WITHOUT LIMITATION, NEGLIGENCE), WARRANTY OR ANY OTHER LEGAL OR EQUITABLE GROUNDS, FOR ANY CONSEQUENTIAL, INDIRECT, INCIDENTAL, LOST PROFITS, SPECIAL, PUNITIVE OR EXEMPLARY DAMAGES, WHETHER TO PERSON OR PROPERTY, ARISING FROM OR RELATING TO THE PRODUCT, EVEN IF PMC HAS BEEN ADVISED OF THE POSSIBILITY OF SUCH LOSSES OR DAMAGES.

Non-Warranty Service by PMC: If PMC determines that the suspected Defect of the Product is not covered by this Warranty, disposition of the Product will be made pursuant to the terms and conditions of PMC's written estimate on a time and materials basis.

Continuing Warranty for Products Repaired or Replaced under Warranty: Following the repair or replacement of a Product covered by this Warranty, such Product will continue to be subject to the original Warranty for the remainder of original Warranty Period or for three (3) months from the repair or replacement date, whichever is longer.

No Rights Implied: Nothing in the sale, lease or rental of any Product by PMC shall be construed to grant any right, interest or license in or under any patent, trademark, copyright, trade secret or other proprietary right or material owned by anyone; nor does PMC encourage the infringement of same.

Exclusive Warranty: This writing is the final, complete, and exclusive expression of the Warranty covering the Product. Any statements made by PMC, its employees or agents that differ from the terms of this Warranty shall have no effect. It is expressly understood that Customer's acceptance of this Warranty, by performance or otherwise, is upon and subject solely to the terms and conditions hereof, and any additional or different terms and conditions proposed or expressed by Customer or anyone, whether in writing or otherwise, are null and void unless specifically agreed to in writing by an Officer of PMC.

SAFETY AND HANDLING

This chapter contains important information on the safety, handling, and use of your Flush Tank.



Before using the Flush Tank, carefully read all the technical and safety documentation included in this manual. Pay special attention to the information in order to know and understand the operation and the conditions of use of the Flush Tank. All of the information is aimed at improving user safety and avoiding possible breakdowns from the incorrect use of the Flush Tank.

WARNING! *Presents information to alert of a situation that might cause serious injuries if the instructions are not followed.*

CAUTION! *Presents information that indicates how to avoid damage to the equipment or how to avoid a situation that could cause minor injuries.*

NOTE! *Is relevant information of a procedure being carried out.*

Careful study of this manual will enable the operator to know the characteristics of the Flush Tank and the operating procedures. By following the instructions and recommendations contained herein, you will reduce the potential risk of accidents; you will provide a better opportunity for incident-free operation for a longer time, greater output, and the possibility of detecting and resolving problems quickly and simply.

Keep this Operations Manual for future consultation of useful information at all times. If you lose this manual, ask for a new copy from your PMC Distributor or go online and visit our web site at www.polymac-usa.com.

The Flush Tank has been designed and built for the flushing of polyurea chemical application guns, polyurethane foam chemical application guns, and some two-component epoxy application guns.

WARNING! The design and configuration of the Flush Tank does not allow its use in potentially explosive atmospheres, or the pressure and temperature limits described in the technical specifications of this manual to be exceeded.

Always use liquids and solvents that are compatible with the unit. If in doubt, consult your PMC Distributor. When working with the Flush Tank, it is recommended that the operator wear suitable clothing and elements of personal protection, including, without limitation, gloves, protective goggles, safety footwear, and face masks. Use breathing equipment when working with the Flush Tank in enclosed spaces or in areas with insufficient ventilation. The introduction and follow-up of safety measures must not be limited to those described in this manual. Before using the Flush Tank, a comprehensive analysis must be made of the risks derived from the products to be dispensed, the type of application, and the working environment.



To prevent possible injury caused by incorrect handling of the raw materials and solvents used in the process, carefully read the Material Safety Data Sheet (MSDS) provided by your supplier.

Deal with the waste caused according to current regulations.



To avoid damage caused by the impact of pressurized fluids, do not open any connection or perform maintenance work on components subject to pressure until the pressure has been completely eliminated.



Use suitable protection when operating, maintaining or being present in the area where the equipment is functioning. This includes, but is not limited to, the use of protective goggles, gloves, shoes and safety clothing and breathing equipment.



The equipment includes components that reach high temperatures and can cause burns. Hot parts of the equipment must not be handled or touched until they have cooled completely.



To prevent serious injury through crushing or amputation, do not work with the equipment without the safety guards installed on the moving parts. Make sure that all the safety guards are correctly reinstalled at the end of the repair or maintenance work of the equipment.

CHARACTERISTICS

- Quick and easy installation
- No electricity required
- Flow control
- Portable and versatile system

TECHNICAL SPECIFICATIONS

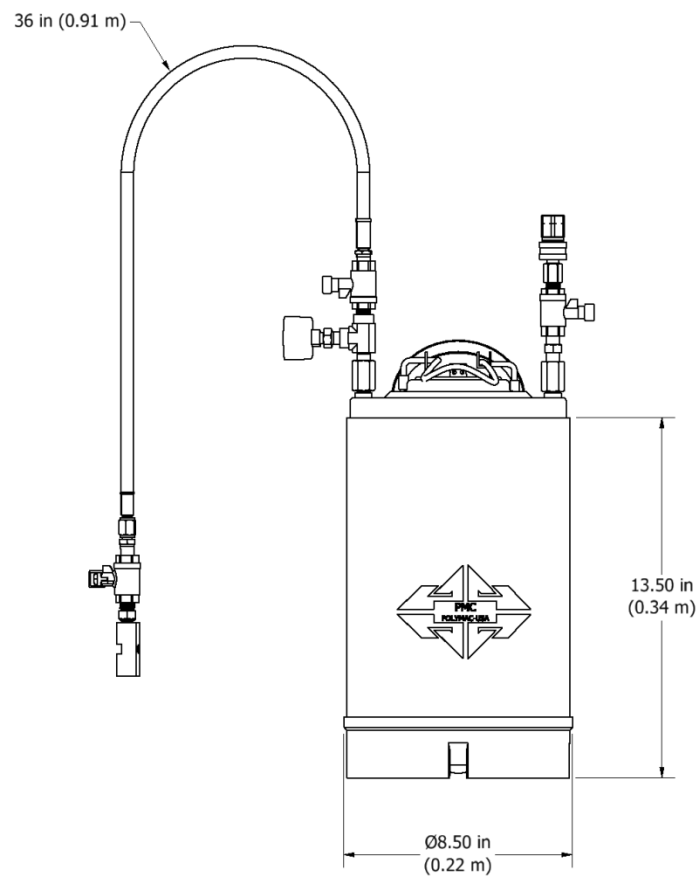

Maximum Working Pressure _____ 100 PSI (7.0 bar)
 Pressure Relief Valve Rating _____ 100 PSI (7.0 bar)
 Air Hose Connection _____ 1/4" Quick Disconnect
 Solvent Hose Length _____ 36 in (0.91 m)

DESCRIPTION

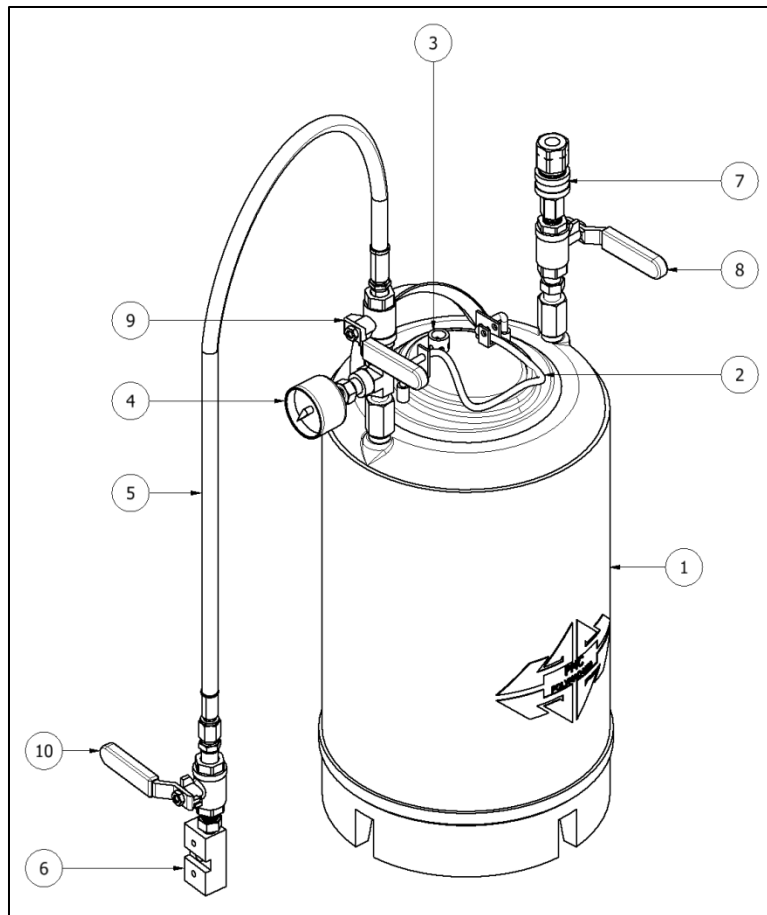

1. Flush Tank Body
2. Flush Tank Lid
3. Pressure Relief Valve
4. Pressure Gauge
5. Solvent Hose
6. Coupling Block
7. Quick Disconnect
8. Inlet Valve
9. Primary Outlet Valve
10. Secondary Outlet Valve

START UP

1. Relieve fluid pressure in the gun (See Gun Manual for proper procedure)
2. If necessary, relieve air pressure in the tank by pulling up on the **Pressure Relief Valve**.
3. Ensure **ALL Valves** are in the closed position.
4. Open the lid and fill tank 2/3 full with compatible solvent.
5. Close and secure the lid.
6. Connect the air supply (130 psi MAX) to the flush tank and slowly open the **Inlet Valve**. After a few seconds, check the **Pressure Gauge** to ensure the pressure has stabilized.
7. Close the **Inlet Valve**, and then disconnect the air supply.

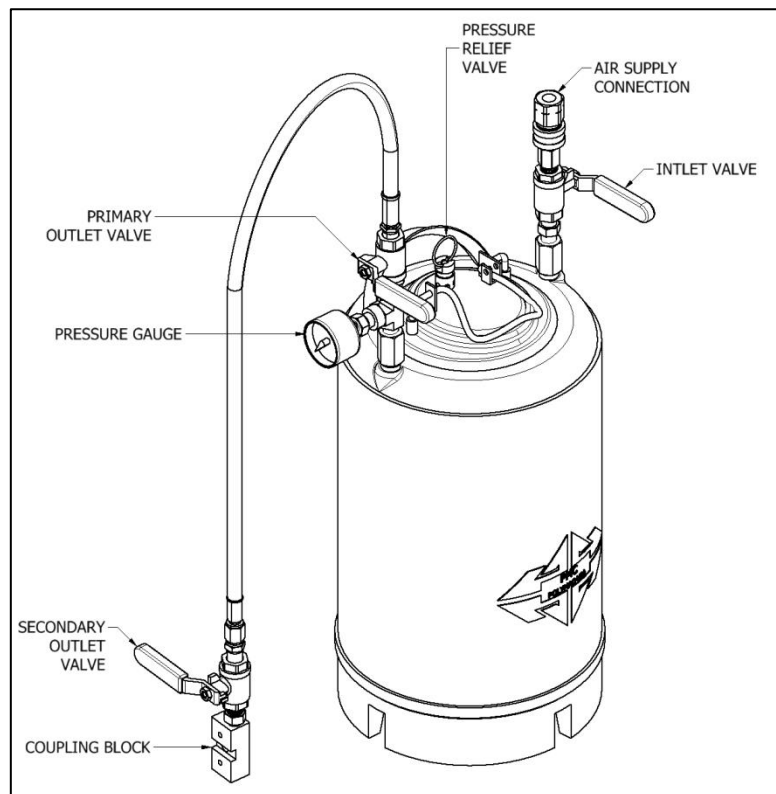

FLUSHING PROCEDURE

1. Ensure **ALL Valves** are closed.
2. Attach the **Coupling Block** to the spray gun.
3. Open the **Primary Outlet Valve**, and then open the **Secondary Outlet Valve**.
4. Direct the gun into a grounded metal pail, ensuring that the flush coupling block is maintaining direct contact with the side of the pail. Flush for approximately 10 seconds.
5. Close the **Secondary Outlet Valve** and purge the remaining solvent in the hose.
6. Close the **Primary Outlet Valve** and disconnect the coupling block from the spray gun.

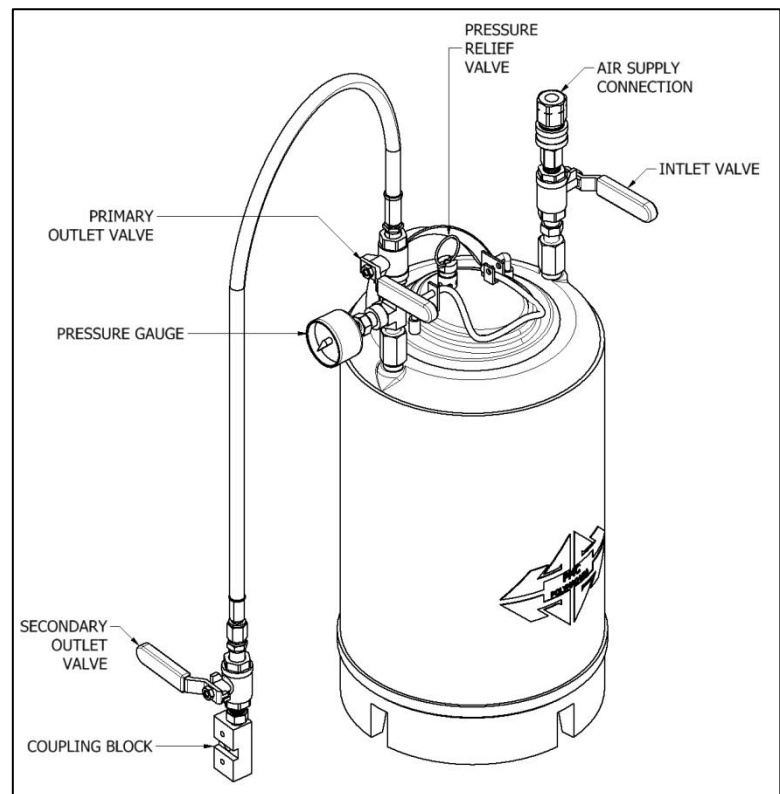

PART IDENTIFICATION

Flush Tank Assemblies

200426, 200427

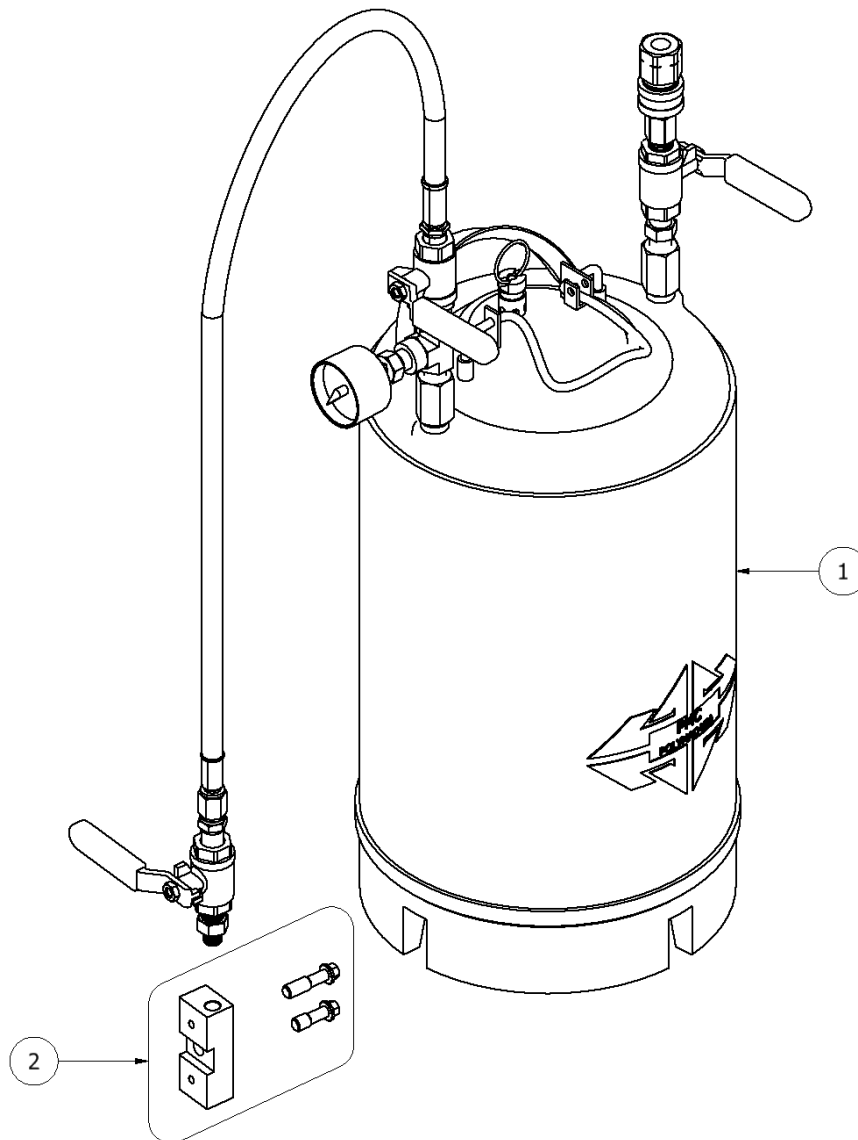

PARTS LIST				
ITEM	QTY	PART NUMBER	DESCRIPTION	INCLUDED IN PART NUMBER
1	1	200413	FLUSH TANK BODY ASSEMBLY	ALL
2	1	HI-05106	COUPLING BLOCK ASSEMBLY, FLUSH KIT, AP	200426
	1	200218	COUPLING BLOCK ASSEMBLY, FLUSH KIT, F-AP	200427

Flush Tank Body Assembly

200413

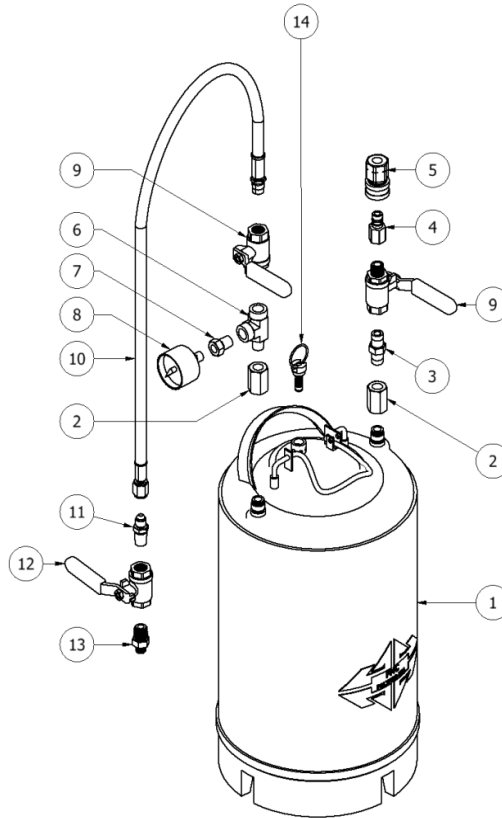

PARTS LIST			
ITEM	QTY	PART NUMBER	DESCRIPTION
1	1	200400	2.5 GAL FLUSH TANK
2	2	200401	FLUSH TANK FITTING
3	1	GP-00100-1	1/4 PIPE NIPPLE
4	1	GU-04022	QUICK DISCONNECT; MALE
5	1	GU-04021	QUICK DISCONNECT; FEMALE
6	1	GP-00100-3	MALE RUN TEE
7	1	HI-05105	NPT REDUCER
8	1	NE-06007	AIR PRESSURE GAUGE
9	2	PU-04000-82	BALL VALVE
10	1	200425	HOSE, FLUSH TANK
11	1	HI-05064	1/4 NPTF X 4 JIC
12	1	HI-05082	BALL VALVE
13	1	HI-05095	1/4 X 1/8 HEX NIPPLE
14	1	SP-3-3	PRESSURE RELIEF VALVE

Coupling Block Assemblies

HI-05106, 200218

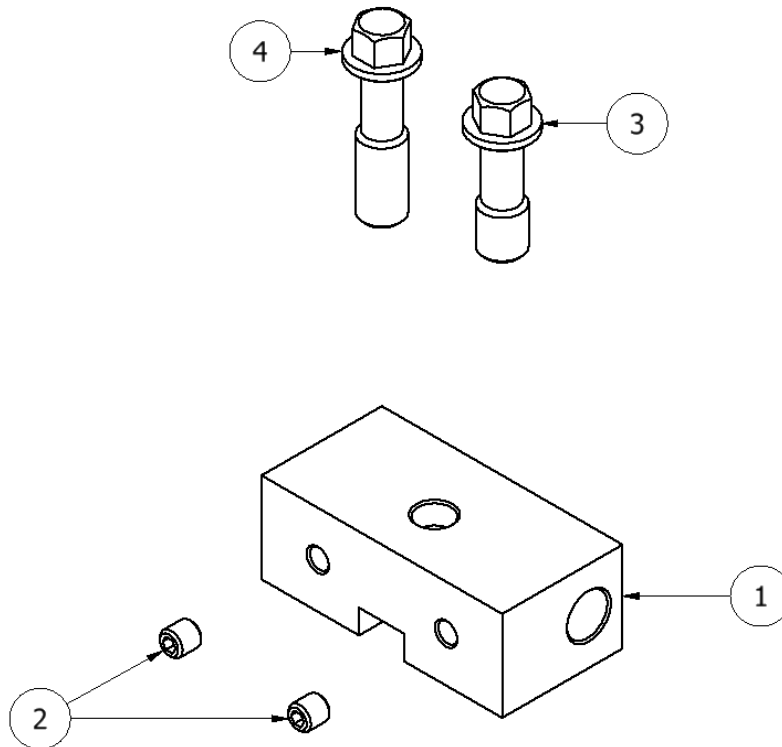

PARTS LIST				
ITEM	QTY	PART NUMBER	DESCRIPTION	INCLUDED IN PART NUMBER
1	1	RM-05106	COUPLING BLOCK, FLUSH KIT, AP	HI-05106
	1	200214	COUPLING BLOCK, FLUSH KIT, F-AP	200218
2	2	TN-04187	SHCS 10-32 X 3/16 PORT PLUG	ALL
3	1	TN-04193	COUPLING BLOCK MOUNTING SCREW	ALL
4	1	TN-04197	COUPLING BLOCK STABILIZER MOUNTING SCREW	ALL

Replacement Tank O-Ring

PARTS LIST		
PART NUMBER	DESCRIPTION	USAGE
OR-00049A	O-RING, #417, VITON	REPLACEMENT TANK SEAL O-RING